

Dunkin Donuts

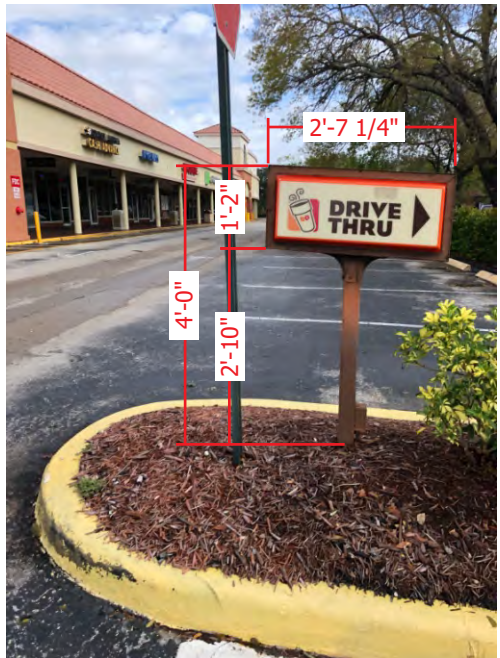

- Nonconforming on-premises signs shall be removed or brought into compliance with the standards of the Sign Code when at least one of the following conditions occur:
- More than 50% of the sign structure is destroyed or damaged, regardless of replacement value
 - There is a change of business which would require a change in a business tax receipt or certificate of occupancy
 - The sign has structural inadequacies that affect its aesthetic appearance or purpose
 - The business or building has been abandoned
 - There is a change in ownership in the business
 - An applicable amortization period has expired.
 - There is a change of tenant in the business

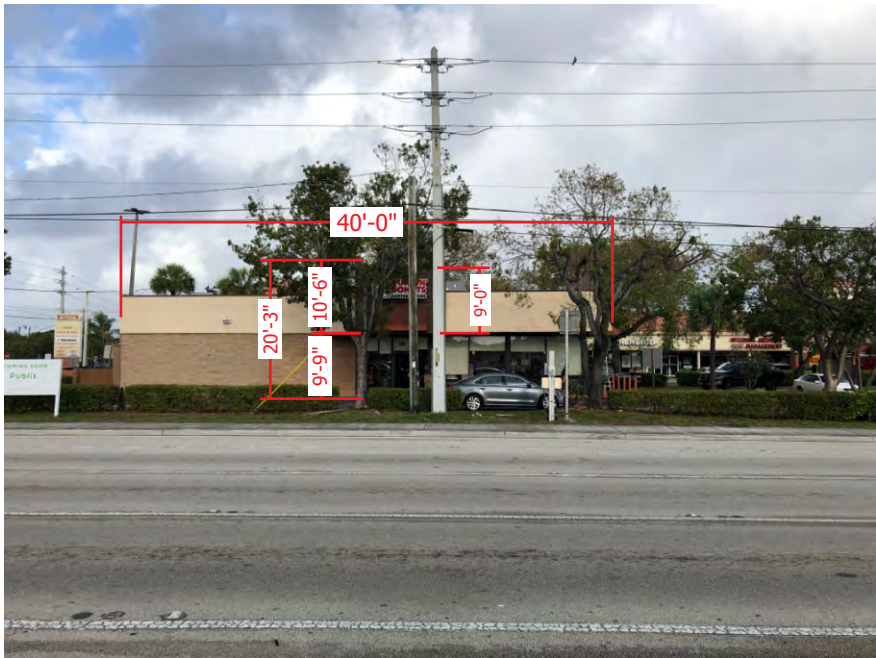